

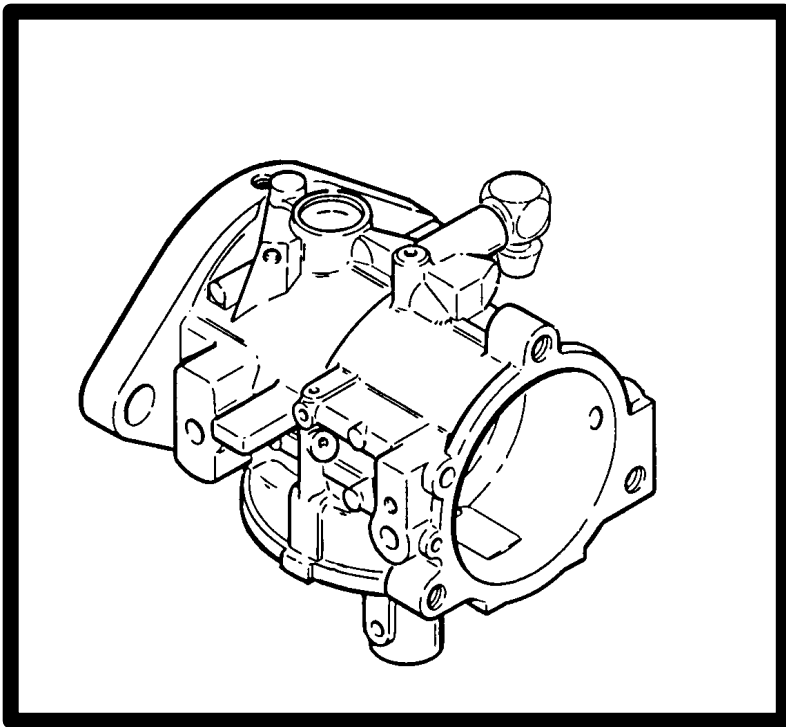

FUEL SYSTEM & CARBURETION



CARBURETOR

3

A



Table Of Contents

	Page
Removing Carburetor	3A-1
Disassembling Carburetor	3A-1
Assembling Carburetor	3A-3
High Altitude Jetting	3A-5
Exploded View - Carburetor - 90/95/120 HP	3A-6



Removing Carburetor

1. Remove nut securing throttle cam to stud.

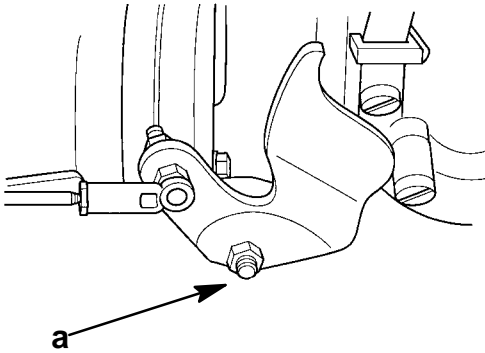

a - Nut, Throttle Cam

2. Remove throttle cam from stud.

NOTE: Carburetors and cover may be removed as an assembly.

3. Remove "E" clips from throttle arm.

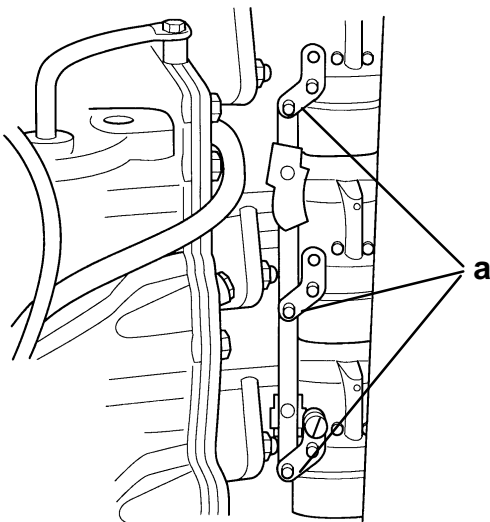

a - "E" Clips

4. Remove throttle bar assembly.
5. Disconnect fuel line.
6. Remove primer hoses from carburetor.
7. Remove carburetor flange nuts.
8. Remove carburetor(s).

Disassembling Carburetor

1. Remove idle mixture screw and spring.

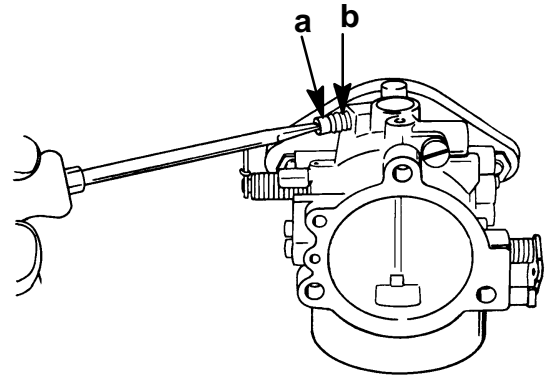

a - Screw, Idle Mixture

b - Spring

2. Remove screw, gasket, fuel bowl, and gasket.

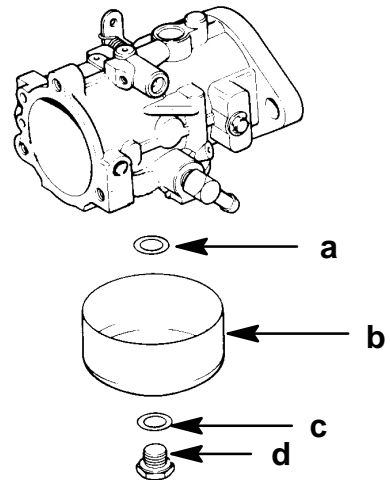

a - Gasket

b - Fuel Bowl

c - Gasket

d - Screw

3. Remove fuel bowl gasket from groove in carburetor.

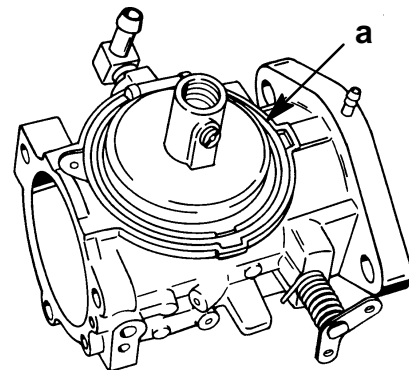

a - Gasket



4. Remove float.

- Drive out float pin.

NOTE: Drive float pin through so that knurled end comes out first.

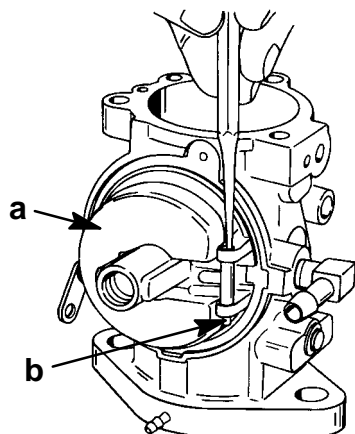

a - Float
b - Pin, Knurled End

- Remove float.

5. Remove inlet needle.

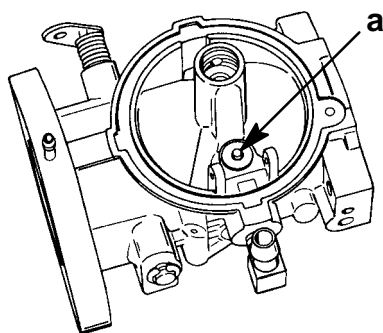

a - Inlet Needle

As Needed

6. Remove throttle assembly.

- Remove screws and washer from shutter.
- Hold throttle in wide open position.
- Pull throttle shutter out of housing.
- Remove E-clip.
- Unhook return spring from drive pin on carburetor.
- Pull throttle shaft out of housing.

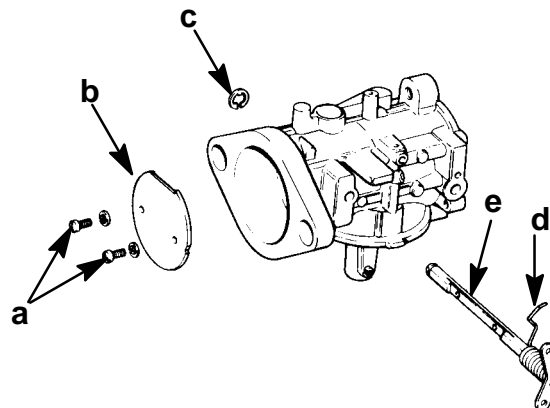

a - Screws and Washers
b - Shutter, Throttle
c - E-Clip
d - Return Spring
e - Throttle Shaft

7. Remove main fuel jet.

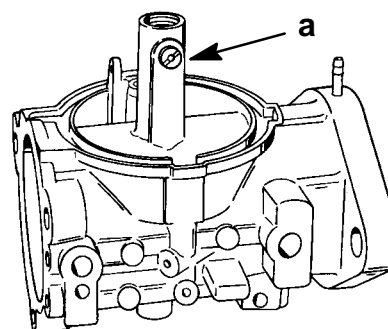

a - Main Fuel Jet

8. 90/95 HP - Remove idle air jet.
120 HP - Remove sealing screw and intermediate fuel jet.

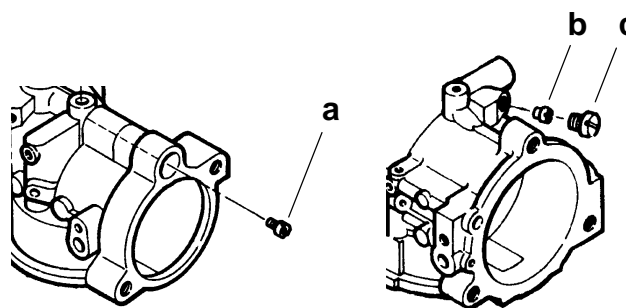

90/95 HP

120 HP

a - Idle Air Jet
b - Intermediate Fuel Jet

c - Sealing Screw



9. Remove elbow.

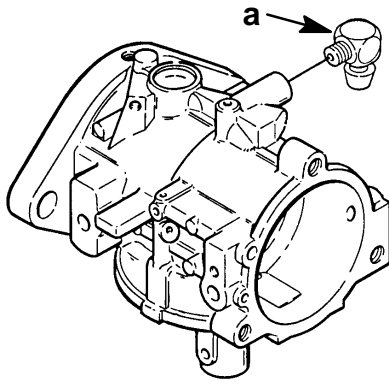

a - Elbow

10. Remove welch plug.

- Drill hole through welch plug.

IMPORTANT: Do not drill into carburetor body.

- Insert a small screwdriver in hole and pry plug out of housing.

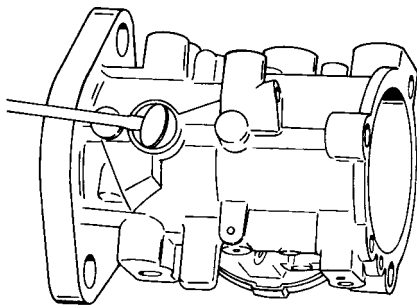

11. Remove idle tube.

- Place punch on bottom end of idle tube.

IMPORTANT: Note the depth of the idle tube prior to removal. It must be installed to this position.

- Carefully tap on punch until cup plug and idle tube come free of body channel.

12. Unscrew main nozzle and remove it from body channel.

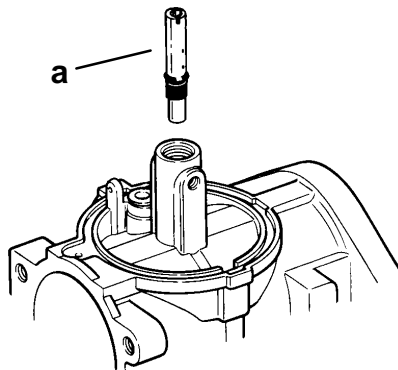

a - Main Nozzle

NOTE: In some cases, the position of the idle tube may make it necessary to remove the tube prior to removing the nozzle.

13. Inspect the following:

Inspect:	Look For:
Idle mixture screw	Rings or grooves on point
Inlet needle	Rings or grooves on point
Idle spring	Compressed spring
Primer connectors	Clogging
Body	Pitting
Jets	Clogging

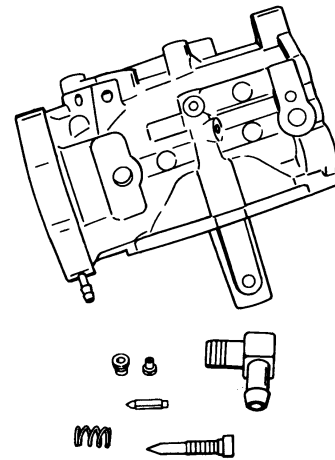

14. Clean entire carburetor with solvent.

IMPORTANT: Do not allow non-metal parts to come in contact with solvent.

⚠ WARNING

Follow solvent manufacturer's directions for use.

Assembling Carburetor

1. Thread main nozzle into body channel.

IMPORTANT: Idle tube must contact nozzle in front or carburetor will run lean.

NOTE: Be sure nozzle is threaded in completely. Do not over tighten nozzle.

2. Install idle tube.

- Slide idle tube (flanged end up) into body channel.

IMPORTANT: Idle tube must contact nozzle in front or engine will run lean.



- Carefully tap cup plug into opening with punch.

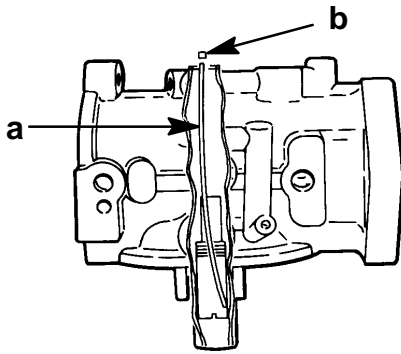

a - Idle Tube b - Cap Plug

- Seal plug with nail polish.
- Place welch plug into recess of carburetor body.
 - Carefully tap center of welch plug.

NOTE: Tapping will spread the plug and hold it in place.

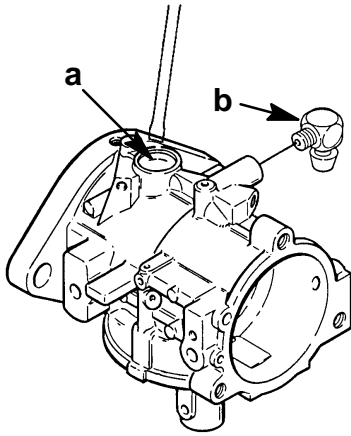

a - Welch Plug b - Elbow

- Seal top of plug with nail polish.
- Install elbow.
 - Install main fuel jet.

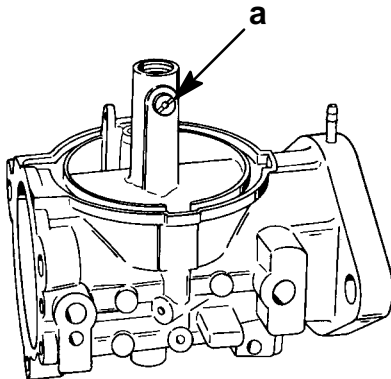

a - Main Fuel Jet

- Install throttle assembly.
 - Slide throttle shaft into carburetor housing.
 - Lay end of return spring on ledge of housing.
 - Secure throttle shaft with E-clip.
 - Turn throttle shaft arm clockwise until flat side of shaft faces up.
 - Slide shutter into slot of shaft with numbered side facing out.
 - Apply Loctite (Special Tool No. FT-8936-1) to screws and install in throttle shutter.

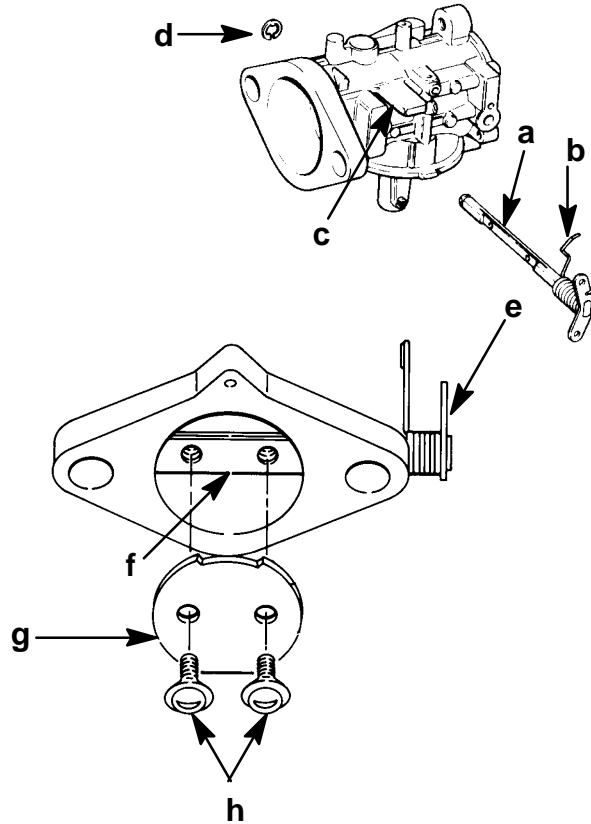

a - Throttle Shaft e - Throttle Shaft Arm
 b - Return Spring f - Throttle Shaft with Flat Side Facing Up
 c - Housing Ledge g - Shutter
 d - E-Clip h - Screws

- Install inlet needle.

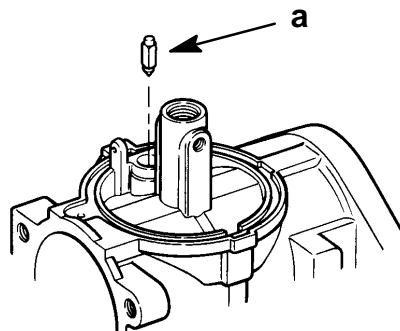

a - Needle



8. Install float.
 - Position float on carburetor.
 - Carefully slide pin through bracket and float.
 - Tap pin until knurled end is retained in carburetor casting.

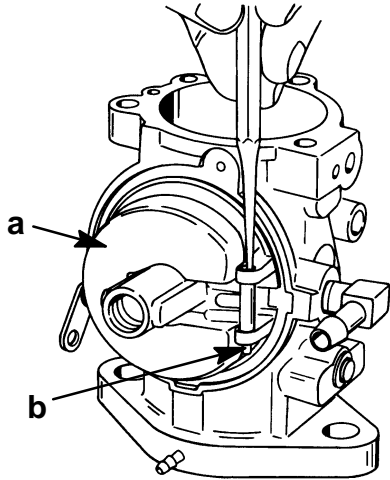

a - Float
b - Pin

9. Measure float height.

NOTE: To adjust, bend inlet needle tab on float until float sits parallel to flange.

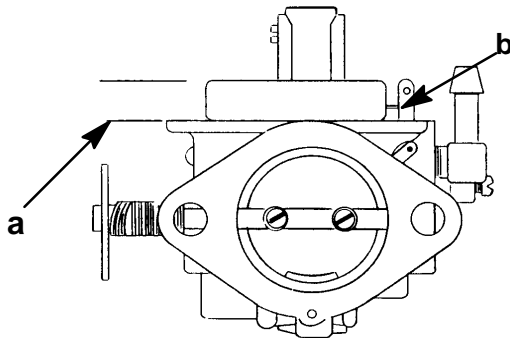

a - Parallel to Flange b - Float Tab

10. Install gasket in groove at bottom of carburetor.

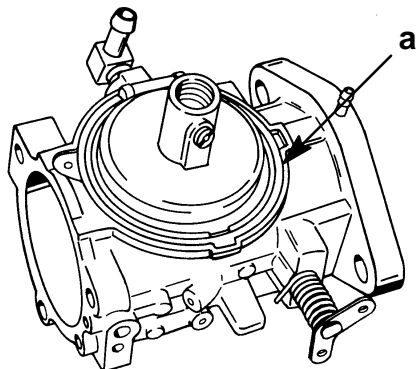

a - Gasket

11. Install fuel bowl assembly: bowl, gaskets, and screw.

High Altitude Jetting

The carburetor jet is for engine operation at sea level through 2500 feet (762 m) above sea level. For engine operation above 2500 feet re-jet the carburetor to the size and altitude specified below.

1995 - 1997 MAIN FUEL JET SIZE 90/95XR HP

Sport Jet Operating Elevation	Carburetor		
	Top	Middle	Bottom
Sea Level-2500 ft.	.072	.072	.074
2500-5000 ft.	.070	.070	.072
5000-7500 ft.	.068	.068	.070
7500-10,000 ft.	.066	.066	.068

1995 MAIN FUEL JET SIZE 120 HP

Sport Jet Operating Elevation	Carburetor	
	Top	Bottom
Sea Level-1500 ft.	.090	.092
1500-3000 ft.	.088	.090
3000-4500 ft.	.086	.088
4500-6000 ft.	.084	.086
6000-10,000 ft.	.082	.084

1996 - 1997 MAIN FUEL JET SIZE 120XR HP

Sport Jet Operating Elevation	Carburetor	
	Top	Bottom
Sea Level-1500 ft.	.088	.090
1500-3000 ft.	.086	.088
3000-4500 ft.	.084	.086
4500-6000 ft.	.082	.084
6000-10,000 ft.	.080	.082



Exploded View - Carburetor - 90/95/120 HP

- 1 - Gasket
- 2 - Plug
- 3 - Plug
- 3a -Tube, Idle
- 4 - Elbow
- 5 - E-Clip
- 6 - Carburetor
- 7 - Idle Jet
- 7a -Sealing Screw
- 8 - Needle
- 10 - Pin
- 11 - Gasket
- 12 - Gasket
- 13 - Bowl
- 13a Bowl (Top Carb)
- 14 - Gasket
- 15 - Screw
- 16 - Float
- 17 -Main Nozzle
- 18 -Main Jet
- 19 - Idle Mixture Screw
- 20 - Spring
- 21 - Screw
- 22 - Roller
- 23 - Nut
- 24 - Shaft
- 25 - Spring
- 26 - Throttle Shutter
- 27 - Screw (2)

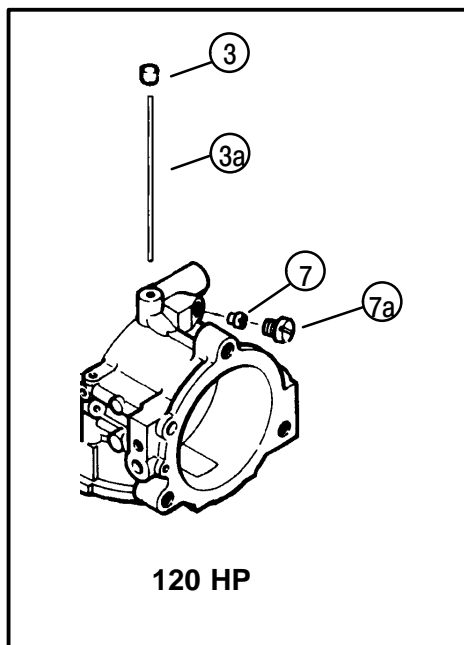
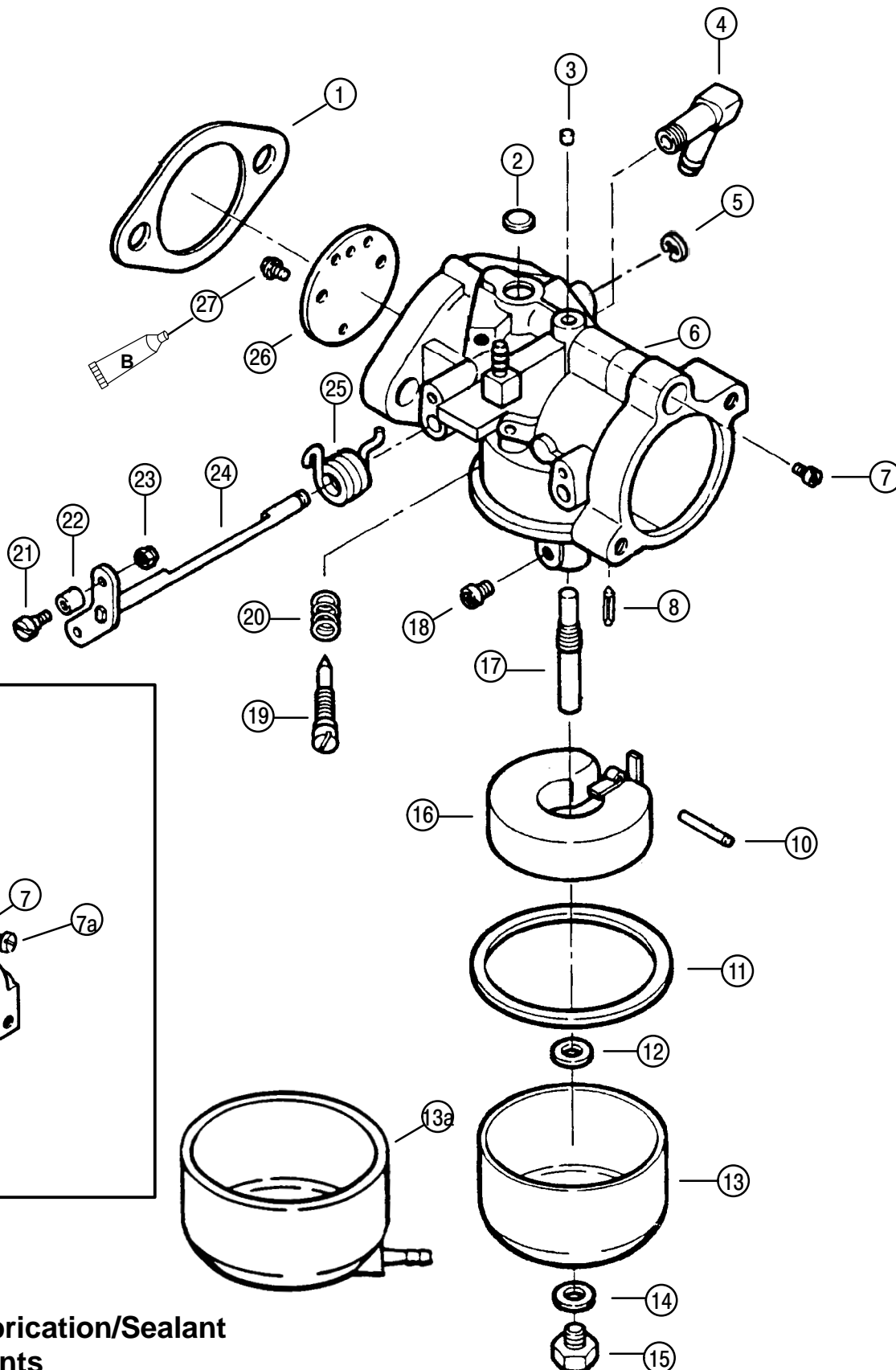

Quicksilver Lubrication/Sealant Application Points

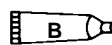
 Loctite 271 (92-823089--1)